



**Deutsche Gesellschaft  
für Kardiologie**

– Herz- und Kreislaufforschung e.V.

# 2012 – Autumn Meeting and Annual Meeting of the Workgroup Rhythmology

cardio  
*live*

AGIK  
*inter*vention

 ARBEITSGRUPPE  
Rhythmologie



**Hamburg**

**CCH**

**Congress-Center Hamburg**

**October 11 - 13, 2012**

**Service Manual  
for Exhibitors**



Online-Order for additional equipment:

<http://ht2012.dgk.org> latest until **14.09.2012**



Please forward all the required information concerning the exhibition to your exhibition stand constructors **promptly!**

01   Contact and Venue .....	3
02   Data of the Exhibition .....	4
03   Directions to the Venue.....	5
04   Parking facilities.....	7
05   Information on Delivery and Installation .....	8
06   Stand information A – Z .....	9
07   Catering .....	14
08   Disclaimer .....	14
09   Approval Form for Stand Construction .....	15
10   Participants' Registration Form for Exhibitors .....	17
11   Congress Center Hamburg .....	19



On the following pages, the most important information for a successful exhibition at Congress Center Hamburg is made available to you. All relevant facts and data on all the aspects of the venue, your exhibition space, the guidelines concerning installation and removal and, last but not least, your contacts can be found here.\*

m:con has extensive experience in organizing congresses and producing events, and offers individual solutions – with its excellent conception and organization and with its own ultra-modern equipment.

The professional team of m:con offers you support at any time.

**m: )con\_providesmore**

**[www.mcon-mannheim.de](http://www.mcon-mannheim.de)**

\* Subject to alterations

■ **Exhibition organization**

m:con – mannheim:congress GmbH  
Bettina Häcker  
Rosengartenplatz 2  
68161 Mannheim  
Germany  
Fon +49 (0)621 / 4106 -105  
Fax +49 (0)621 / 4106 - 80 105  
[bettina.haecker@mcon-mannheim.de](mailto:bettina.haecker@mcon-mannheim.de)

■ **Organizer / Scientific responsible body**

Deutsche Gesellschaft für Kardiologie  
– Herz- und Kreislaufforschung e.V.  
Achenbachstr. 43  
40237 Düsseldorf  
Germany  
Fon +49 (0)211 / 600692 - 0  
Fax +49 (0)211 / 600692 -10  
[info@dgk.org](mailto:info@dgk.org)

■ **Venue**

CCH - Congress Center Hamburg  
Am Dammtor / Marseiller Str.  
20355 Hamburg  
Germany

Fon +49 (0)40 / 3569 - 0  
[info@cch.de](mailto:info@cch.de)  
[www.cch.de](http://www.cch.de)



#### ■ Times and instruction for installation

Wednesday	10.10.2012	07.00 - 22.00 hrs
Thursday	11.10.2012	07.00 - 12.00 hrs

From 22.00 hrs on, installation is only allowed inside the house and with prior consultation and approval by the organizer.

Please note:  
Unloading until  
22.00 hrs only!

#### ■ Opening times of the exhibition

Thursday	11.10.2012	13.00 - 22.00 hrs (from 19.00 hrs on <i>Get Together</i> in the exhibition area)
Friday	12.10.2012	08.00 - 19.00 hrs
Saturday	13.10.2012	08.00 - 13.00 hrs

#### ■ Times and instructions for removal

Saturday	13.10.2012	13.15 - 24.00 hrs
----------	------------	-------------------

From 22.00 hrs on, removal is only allowed inside the house and with prior consultation and approval by the organizer.

Please observe the instructions for removal in any case, otherwise current and following events may be disturbed. Stands that are not removed in time are cleared at your costs!

Please note:  
Loading until  
22.00 hrs only!





Route via the city center



Access for deliveries to Hall 3 of Congress Center Hamburg via Gate D +E, Tiergartenstraße 2

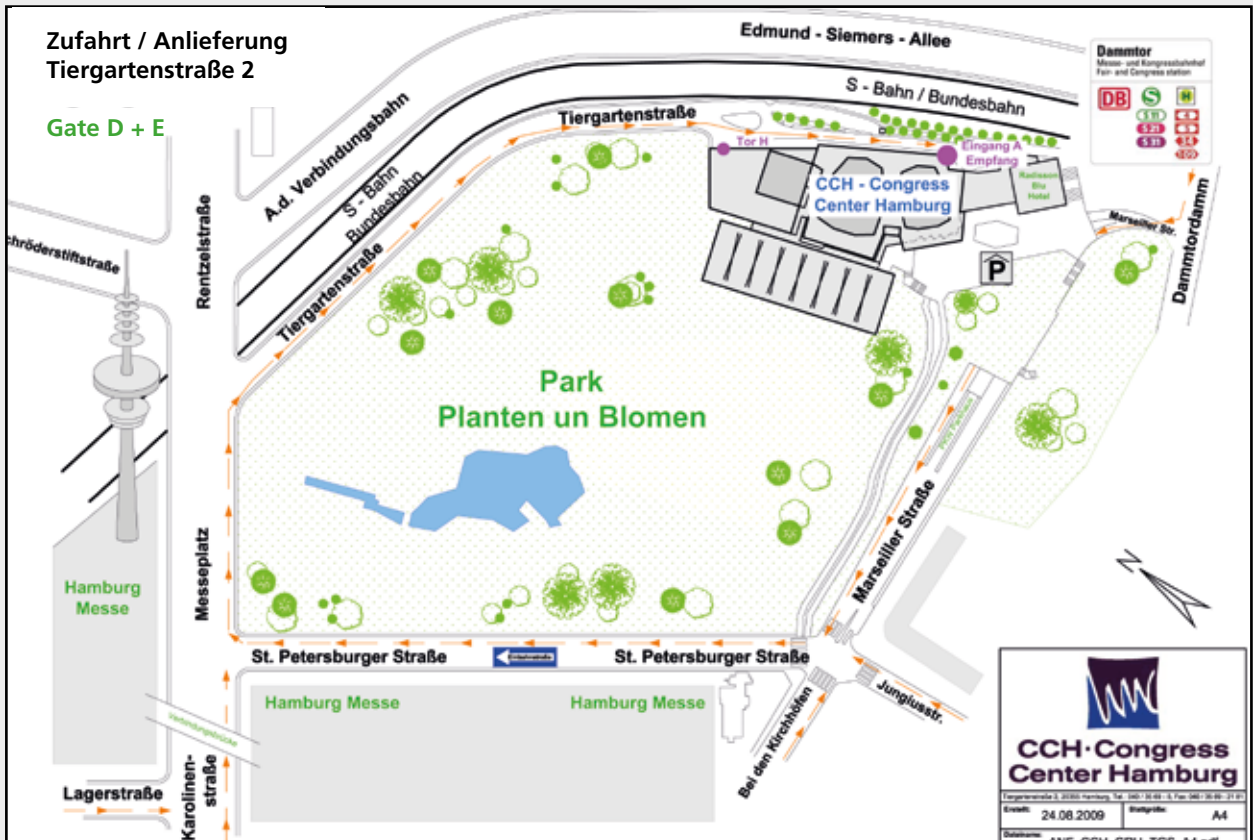





■ Parking facilities for cars



For parking cars please use the Congress Center Hamburg underground car park "CCH / Messe" with costs.

■ Parking facilities for Heavy goods vehicle

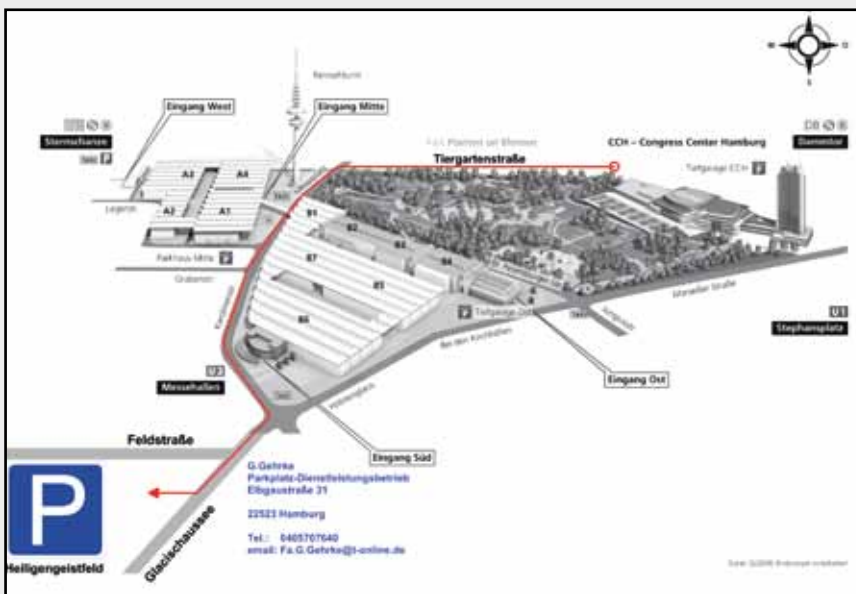

Heavy goods vehicle can be parked with costs at the parking lot „Heiligengeistfeld“.



### ■ Delivery

Owing to a shortage of space, deliveries can be carried out only on the days of installation. For organizational reasons, earlier deliveries have to be carried out by a forwarding company (address see "Storage", page 7) **at your expense**, otherwise they are returned **at your costs**.

For deliveries of advertising material, brochures and other articles, please indicate the following extended address:

**Congress Center Hamburg**  
**Autumn Meeting of the German Cardiac Society 2012**  
**Company name**  
**Name of your contact at the exhibition**  
**Mobil number of your contact at the exhibition**  
**Stand number:**  
**Tiergartenstr. 2, Eingang A**  
**20355 Hamburg**  
**Germany**

Please note that deliveries have to be effected directly to the stand area. Congress Center Hamburg and the congress organizer do not accept any deliveries. **All deliveries are left to the owner's risk:** m:con and the congress organizer do not assume any responsibility for deliveries.

Congress Center Hamburg and the congress organizer do not accept any deliveries and do not assume any responsibility for deliveries: all deliveries are left to the owner's risk.

### ■ Unloading on the exhibition grounds of Congress Center Hamburg

The access to the Congress Center Hamburg from "Tiergartenstraße" has a gate opened by a porter. Please enter Gate D + E to enter the loading zones to Hall 3. Only vehicles higher than 1.90 m may be parked on the forecourt during installation and removal and only for loading and unloading purposes! Vehicles shall be promptly unloaded and removed forthwith from the grounds.

Please note that cars which are used for delivery and collection have to be parked in the underground car park at your costs.

Should pallets be delivered, please note that Congress Center Hamburg cannot provide a hand pallet truck. It has to be provided by the exhibitor.

Vehicles shall be promptly unloaded and removed forthwith from the grounds.

### ■ Storage

It is absolutely impossible to store any kind of exhibits or empties before, during or after the exhibition at the Congress Center Hamburg. The storage of empties can be dealt with by a forwarding company.

For questions and orders please contact Hamburg Messe und Congress GmbH:

**Hamburg Messe und Congress GmbH**  
 Exhibitor Service  
 Fon +49 (0)40 3569 - 7575  
 Fax +49 (0)40 3569 - 2138





The legal stipulations and regulations in their most current form must be observed for all exhibition stands, facilities, exhibits, materials and advertising that are brought into the Congress Center Hamburg.

Please note also the Technical Regulations of the Congress Center Hamburg at [www.cch.de/en/downloads/contractual-regulations](http://www.cch.de/en/downloads/contractual-regulations).

#### ■ Additional orders

Orders for additional equipment can be placed online <http://ht2012.dgk.org> until **14.09.2012**.

After the above-mentioned date, orders can be placed on site only plus an extra charge of 20 %! Orders on site are payable immediately!

Orders for additional equipment only online!

#### ■ Advertising

Any sort of advertising is only allowed within the stand rented by the exhibitor and only for the exhibitor's own company and the exhibited articles manufactured or distributed by the exhibitor's own company. All advertising effort outside the stand area has to be approved by the organizer of the exhibition.

The distribution and the display of printed matters and advertising material outside the own stand area is only allowed by our licensed service partner. Should you be interested, please refer to:

Dr. Wilhelmus GmbH  
Mr. Wilhelmus  
Fon +49 (0)2204 / 66272  
Fax +49 (0)2204 / 22747  
[info@dr-wilhelmus.de](mailto:info@dr-wilhelmus.de)

#### ■ Audiovisual presentations

Any kind of presentations on the stand requires the organizer's approval. Approval is granted with the pre-requisite that the presentation will not negatively affect or interrupt neighbouring stands and the ongoing congress. The organizer shall have the right to cancel a presentation in the event of disregard for his regulation.

Under the provisions of the Performing Rights Act, Art. 15 Copyright Act (German Official Journal, in version as valid from time to time), permission from

The Society for Musical Performance and Mechanical Reproduction Rights (GEMA) is required for sound reproduction in any form. Please contact:

#### GEMA, Bezirks-Direktion Hamburg

Schierenberg 66  
22145 Hamburg  
Fon +49 (0)40 / 6790 - 93 0  
Fax +49 (0)40 / 6790 - 93 700  
[bd-hh@gema.de](mailto:bd-hh@gema.de)

#### ■ Construction height

The maximum construction height for stands is 3.00 m.

Prior approval by the organizer is necessary for construction heights exceeding these limits.

In general, a maximum flooring height of 2.5 cm is permitted. Exceeding construction heights require a written approval by the organizer and have to show canted edges.

The maximum construction height is 3,00 m.

#### ■ Damage

The exhibitor is responsible for damage to facilities of Congress Center Hamburg, floors etc., as well as to material let or lent to him.

#### ■ Disposal

In general, reusable and eco-friendly materials have to be used for the installation and the operation of a stand. It is not allowed to leave any materials at Congress Center Hamburg. Any materials left are disposed of without checking the value at the exhibitor's cost and at a higher charge.

In general, reusable and eco-friendly materials have to be used for the installation and the operation of a stand.



### ■ Electricity

The laying of electrical cables outside the stand, as well as connection to the supply network may only be carried out by Congress Center Hamburg. For electrical installations inside the stand, as well as for the laying of electrical cables, the instructions of VDE have to be observed. It is recommended to order Congress Center Hamburg to carry out the work inside the stands as well.

The equipment and the illumination of the stands have to be disconnected from the grid by the exhibitor after the end of the exhibition and before leaving the stand respectively. In case of non-observance as to the above mentioned switching off regarding equipment and illumination, m:con reserves its right to charge any costs that may result from additional consumption of electricity to the exhibitor's account.

The exhibitor is responsible for the self-installation on the stand. If you wish electrical installations at a certain place, we ask you to let us have a sketch accordingly. If you require electricity, you can place your order online.

The equipment and the illumination of the stand have to be disconnected from grid before leaving the stand respectively!

### ■ Emergency exits and escape routes

The aisles between the exhibition areas serve as escape routes in cases of Emergency. At no time should these aisles should be blocked. Escape routes must always be kept free of hindrance.

The exit doors, emergency exits and their signposting must never be obstructed, built over, closed in, obstructed by drapes or disfigured in any way.

### ■ Empties

During the installation, the duration of the congress and the removal, it is not allowed to store empties on the stands, outside the stands, inside the Congress Center Hamburg and in its outside area. Dispatch and storage of empties can be dealt with by a forwarding company (address see "Storage", page 7).

### ■ Examination of the rented space

After the assignment of space, exhibitors must make themselves aware of any fixtures, in particular hall pillars, fire alarms, wall hydrants, ventilation systems, as well as uneven flooring. m:con shall not be responsible for the accuracy of dimensions on hall and stand plans.

### ■ Exhibition construction company

The exhibitor's service handbook and all important information according the exhibition have to be forwarded to the exhibition construction company and other service providers by the exhibitor.

The exhibitor's service handbook (in German and in English) is at your disposal on the internet at <http://ht2012.dgk.org> at any time.

The exhibitor's service handbook is at your disposal on the internet at any time.

### ■ Exhibitor cards

Exhibitor cards can be ordered via e-mail at [isabel.peter@mconmannheim.de](mailto:isabel.peter@mconmannheim.de) until **02.09.2012**. Please indicate names and number of persons in your e-mail. Exhibitor cards do not entitle the bearer to admittance to lectures!

### ■ Fire protection

All materials of the stand have to be flame-resistant according to DIN 4102-1 (B1). The exhibitor must be able to furnish proof of flame-resistance on the stand at any time.

The fire extinguishers, wall hydrants and emergency buttons at Congress Center Hamburg must not be blocked or made inaccessible under any circumstances. It is not permitted to render the instruction signs illegible.



### ■ Floor covering

Hall 3: Parquett flooring

Floor coverings and other floors have to be laid accident-proof and must not project over the boundary of the stand. If you lay floor coverings using double-sided adhesive tape, please note that it has to be removed without residue on removal. Remaining residues will be removed at the exhibitor's cost.

The maximum floor loading capacity is 500 kg per sqm. In case that heavier exhibits are to be installed, it has to be arranged with and approved by the organizer. Loads should be distributed, concentrated heavy loads have to be avoided at any rate.

If you lay floor coverings using double-sided adhesive tape, please note that it has to be removed without residue on removal.

### ■ Forklift trucks / hand pallet trucks

Please note that Congress Center Hamburg cannot place forklift trucks and hand pallet trucks at your disposal. This service can be dealt with a forwarding company (address see "Storage", page 7). Please note that the use of forklift trucks is not allowed inside.

### ■ Glass and plexi-glass constructions

Only safety glass may be used in the construction of superstructures. Glass panes must be of a round edge construction or finished in such a way that potential injury risks are ruled out. Constructions made entirely of glass are to be marked at eye level.

Safety glass must be used for any superstructures. Edges of glass sheets must either be rounded or designed in such a way that there is no risk of injury. Structures made entirely of glass must be marked at eye height.

### ■ Guarding

The organizer of the exhibition provides a general guarding without accepting responsibility for damage or loss. Articles brought to Congress Center Hamburg are at the owner's risk, m:con accepts no responsibility for articles deposited. The exhibitor has to take care of a special guarding for his stand and goods himself. Stand guarding service can only be ordered online.

### ■ Hazardous materials

It is forbidden to use open fire or naked light, e.g. spirit, fuel, oil, gas, etc.

### ■ Hotel accommodation service

If you wish to book a hotel room, please contact:

#### HRS Groups & Convention

Sandra Rutkowski

Fon +49 (0)221 / 2077 - 3520

Fax +49 (0)221 / 2077 - 388

Sandra.Rutkowski@hrs.de

www.HRS.com

### ■ Householder's rights

Congress Center Hamburg and the service providers commissioned by Congress Center Hamburg shall have householder's rights vis-à-vis the exhibitors, their builders and all individuals located in the exhibition space. The organizer shall have the right to expel from the Congress Center Hamburg individuals who do not adhere to the regulations of Congress Center Hamburg or the services providers commissioned by Congress Center Hamburg or who violate the conditions for participation. The organizer shall also have the right to ban these individuals. Congress Center Hamburg, m:con, persons commissioned by m:con, the police, the fire department and the supervisory authority shall have access to the stands at any time.

### ■ Illumination

Possibly, the general illumination at Congress Center Hamburg is not sufficient to illuminate the individual stands effectively. In your own interest, we recommend to plan on additional installation of illumination on your stand.

### ■ Information counter for exhibitors

During the congress an information counter for exhibitors will be operated at the conference counter where an employee of ours will be at your disposal for repeat orders and for any queries concerning your participation in the exhibition that may occur.



### ■ Installation of stands

All stands have to be installed as self-supporting constructions. Fastenings on the walls, pillars and floors of the halls are not allowed. Pillars, buttresses, projections etc. within the exhibition area are part of the allocated space. It is not allowed to exceed the allocated space for installation. Sticking up of advertising material on the walls, pillars or other parts of the venue is not allowed. The exhibitor is liable for any damages owing to violations and is responsible for the security of the stand; they must provide evidence of this.

Lighting facilities and signs may not exceed the limits of the stand. m:con retains the right to bill for any additionally used space.

Escape routes, fire alarms, hydrants, electrical distributors, switchboards and telephone distributors have to be accessible. A minimum safe distance of 0.5 m to the ceiling sprinklers has to be kept.

Rear sides of stands which are visible and back onto neighbouring stands or those stands which are free standing must be of a smooth construction and neutral colour (white or light grey). The exhibition organizer reserves the right to insist on the modification of stands which are deemed inadequate or non-approved along with the right to order the removal of inappropriate exhibits when these are either bothersome or dangerous to visitors or exhibitors. Serious security defects can also lead to either partial or complete closure of the stand.

Escape routes, fire alarms, hydrants, electrical distributors, switchboards and telephone distributors have to be accessible.

### ■ Insurance

The exhibitor shall be liable for all personal and material damages that arise from the operation of their exhibition stand and materials. It is recommended that the exhibitors obtain adequate insurance protection.

### ■ Internet access / EDP

Please note that in case of orders for internet access, the configuration or installation of additional hardware and software brought by the customer is not included in the range of delivery. The exhibitor is responsible for the observance of the licensing agreement in case of software brought by himself. Internet access can only be ordered online. The exhibitor is responsible for the rented technical equipment for the duration of the rent.

### ■ Motor vehicles

The exhibiting of motor vehicles must always be approved of by the exhibiting organization. Motor vehicles with internal-combustion engines may only be exhibited in Congress Center Hamburg if the tank of the vehicle has been emptied to a maximum of 5 liters of gasoline and filled up with nitrogen, and also only if the battery cables have been disconnected.

### ■ Smoking

**Smoking is strictly forbidden in the whole inside area of the Congress Center Hamburg at any time.**

Smoking is strictly forbidden in the whole inside area of the Congress Center Hamburg at any time!

### ■ Stand roofs

As a matter of principle, stands must be open at the top. This is to ensure sprinkler protection. Roofs shall only be possible in exceptional cases and must be approved by the exhibition organization. Evidence of sprinkler suitability must be kept on hand in any stand with an approved roof.

### ■ Storage of information material and brochures

The storage of informational material is only permitted in the amount required for that given day and only on the stand surface. Storage outside of the assigned stand surface is not permitted.



#### ■ Suspensions

Prior approval by the organizer of the exhibition is necessary for suspensions. They are only allowed in exceptional cases.

#### ■ Theft

In order to keep the danger of theft as low as possible, we ask you, in your own interest, not to leave your stand unattended after the delivery of exhibits. In general, a stand guarding, especially for the nights, is to be recommended. In any case, you should lock away valuable goods during the night.

We recommend you never to leave your stand unattended during the opening hours and to make goods in danger of theft especially secure. On removal, we ask you not to leave your stand before valuable goods have been loaded or handed over to the carrier. If this is not possible, it is advisable to book a stand guarding.

#### ■ Vouchers for the congress

In the run-up of the exhibition, you can hand out vouchers for the congress to your customers. The layout of the vouchers for the congress can be taken on by yourself. We ask you to send a draft of it to m:con participants registration, Ms. Isabel Peter, E-Mail: [Isabel.peter@mcon-mannheim.de](mailto:Isabel.peter@mcon-mannheim.de) for approval latest until 10.09.2012. There will be a cashing-up of vouchers according on the number of vouchers exchanged.



## 07 | Catering

Food and beverages for catering on your stand are provided by the service partner of Congress Center Hamburg:

### **Stockheim Catering Hamburg GmbH**

Ms. Elisabeth Rieber

Tiergartenstraße 2

20355 Hamburg

Germany

Fon +49 (0)40 / 3569 - 3109

elisabeth.riever@stockheim.de

Please note that orders for food and beverages can only be placed via this licenced caterer. If you wish to be supplied by another service, prior arrangements have to be made. The Stockheim Catering Hamburg GmbH may charge a fee for the transfer of its catering rights which is based on the number of sqm space per day of exhibition plus VAT. Therefore it is absolutely necessary to consult our service partner.

## 08 | Disclaimer

Articles brought into our house are at the owner's risk, m:con and Congress Center Hamburg accept no responsibility for articles deposited. There is no guarding at the exhibition. Stand guarding service can be ordered online.

Should you have any further questions concerning the exhibition, please get in touch with the indicated contacts.

Articles brought into our house are at the owner's risk. m:con and Congress Center Hamburg accept no responsibility for articles deposited.





Above construction heights of 2.50 m  
please reply at latest until **14.09.2012**.

**Fax +49(0)621 / 4106 - 80 105**

**m:con – mannheim:congress GmbH**  
Exhibition Organisation  
Bettina Häcker  
Rosengartenplatz 2  
68161 Mannheim  
Germany

## 2012 – Autumn Meeting and Annual Meeting

of the Workgroup Rhythmology

October 11 - 13, 2012

Congress Center Hamburg

Please fill it out distinctly in block letters:

_____	_____
Exhibitor	Stand Number

<b>Booth building company</b>	
_____	_____
Company / Organisation	First Name / Surname (Contact)
_____	_____
Street / P.O. Box	Fon
_____	_____
Post Code / City	Fax
_____	_____
State / Country	e-mail
_____	_____
Contact onsite	Mobile Phone onsite

Herewith we submit the blueprint of the stand (minimum scale 1:100 or as digital plan with dimensioning). This is drawn up in accordance with the guideline of the exhibitor manual.

- Audio-/visual presentations are planned on the stand.
- Our planned stand height \_\_\_\_\_ m.
- Stand height confirmed by m:con \_\_\_\_\_ m.
- Our planned floor height of the stand \_\_\_\_\_ m.
- Floor height of the stand confirmed by m:con \_\_\_\_\_ m.

Place, Date

Legally binding signature





Please send back by **02.09.2012**:  
Fax +49 (0)621 / 4106 - 80 174

## 2012 – Autumn Meeting and Annual Meeting

of the Workgroup Rhythmology

October 11 - 13, 2012

Congress Center Hamburg

**m:con – mannheim:congress GmbH**  
Participants' registration  
Isabel Peter  
Rosengartenplatz 2  
68161 Mannheim, Germany  
Tel. +49 (0)621 / 4106 - 174  
isabel.peter@mcon-mannheim.de

Please fill it out distinctly in block letters:

Booth Number	Company / Organisation
First Name / Surname (Contact)	Street / P.O. Box
Post Code / City	Fon / Fax
State / Country	e-mail

### Exhibitor card (index of names required)

2 exhibitor cards are free of charge up to an exhibition area of 10 sqm, plus 2 exhibitor cards per 10 additional sqm. Additional cards are available at a price of € 25.00 (additional 19% of VAT) each.

**We are ordering** \_\_\_\_\_ items exhibitor cards free of charge \_\_\_\_\_ items exhibitor cards subject to a charge (index of names required)

The holder of an exhibitor card is entitled to participate in the exhibition; he has no access to the lectures. In order to have access to the lectures, congress tickets have to be ordered separately. (index of names required) **After 02.09.2012 exhibitor cards free of charge cannot be ordered anymore. On the spot, only exhibitor cards subject to a charge can be made out.**

### Congress tickets (index of names required)

1 congress ticket is free of charge up to an exhibition area of 6 sqm, 3 congress tickets are free of charge up to an exhibition area of 50 sqm, 5 tickets are free of charge with an exhibition area of over 50 sqm.

\* plus VAT

day ticket/s 11.10.2012 _____ items € 55.00 each
day ticket/s 12.10.2012 _____ items € 65.00 each
day ticket/s 13.10.2012 _____ items € 55.00 each
ticket/s for the congress valid for all days _____ items € 90.00 each

symposium ticket/s 11.10.2012 _____ items € 25.00* each
symposium ticket/s 12.10.2012 _____ items € 25.00* each
symposium ticket/s 13.10.2012 _____ items € 25.00* each
Congress ticket/s free of charge _____ items

**Please note that the stated prices are reduced prices that are only valid if the registration is made in advance and if the invoice amount is paid by 02.09.2012 at the latest. For all orders for congress tickets received after that date, the regular price will be charged.**

The price for the day ticket and the price for the ticket valid for all days include one program each which you will receive onsite. If you wish additional fee required programs to be delivered in advance, please send an order via e-mail by 02.09.2012.

If you wish to hand out vouchers for the registration to the congress to your customers, the layout of the vouchers for the congress can be taken on by yourself. We ask you to send us a draft of it before the congress starts by 10.09.2012 at the latest. There will be a cashing-up of vouchers according to the number of vouchers exchanged. The regular price will be charged for up to 40 traded voucher. Anything over that will be charged at the reduced, early bird price.

**All tickets are personalized, please enclose a list subdivided into categories respectively day with the names of people who need tickets. We can't arrange your registration without list.**

**If you appoint the identifications by m:con until 02.09.2012 and the payment is done, then we will send it to you prior to the congress. Tickets ordered after 02.09.2012 will only be handed out on site. Payment (by cash, Maestro card, Visa, Mastercard) can only be made on site. After 01.10.2012 registration is only possible at the registration desk onsite.**

Your registration is firm committing you to pay the participation fee. If the exhibition is cancelled by the organiser, the participation fee will be repaid. There are no further legal claims.

If the participant withdraws – even if it is no fault of his own – by 8 days before the congress starts, a service charge for the cancellation of the congress tickets of € 35.00 and for the cancellation of exhibitor cards subject to a charge, a service charge of € 10.00 will be withhold / charged. In case of cancellations after that date, the registration fee cannot be repaid.

**A service charge of € 10.00 is charged for rewritings of names. Please note that exhibitor cards and congress tickets subject to charge cannot issued before the invoice amount has been paid in full.**

Place, Date

Legally binding signature





Ground Floor



1. Floor

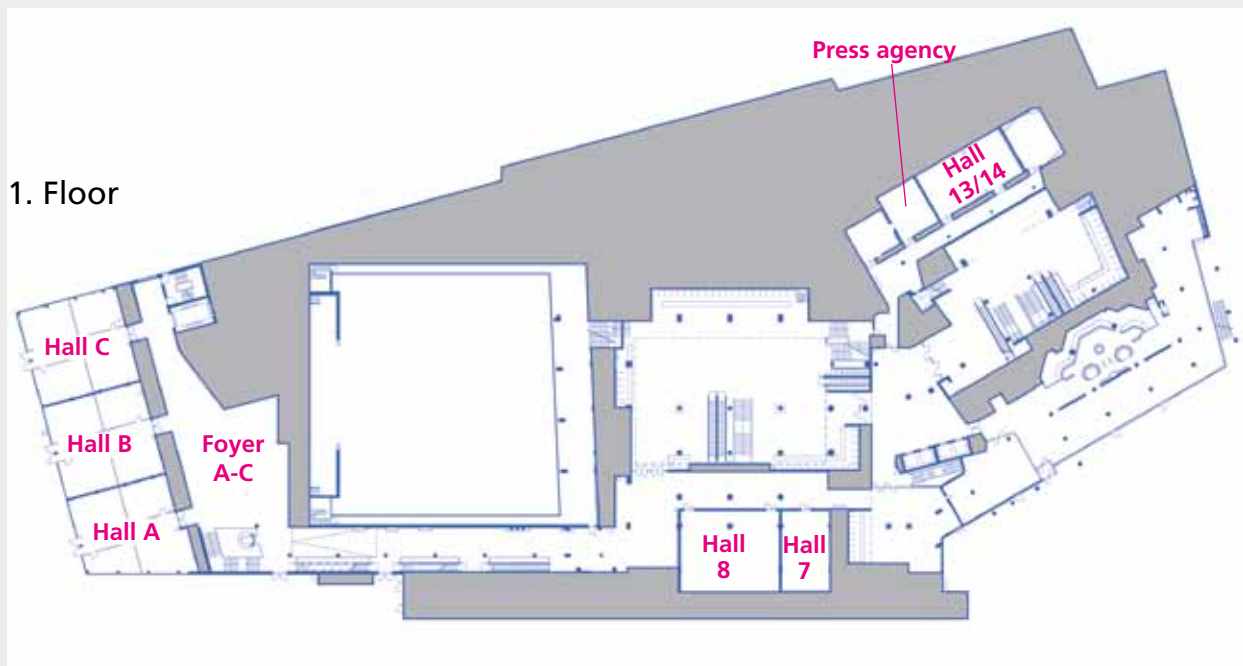

2. Floor



# m:con. Know-how to realise your vision.



## **m:con**\_vidoc

Conferences, conventions and events with no limit to the number of participants. This platform, which was developed especially for m:con, allows you to make speeches, presentations and symposiums available to an additional market segment either by live-stream or on-demand (fee-based). m:con\_vidoc presents the speech or discussion as a video with simultaneous on-screen display of the presentation slides.

For more information, contact:  
thomas.hohm@mcon-mannheim.de

[www.mcon-mannheim.de](http://www.mcon-mannheim.de)

## **m:con**\_mobile Kongressguide

Using the free, mobile m:con conference guide, visitors can quickly and conveniently access all information about a particular event on their smartphone, laptop or tablet computer. The web app is put online before the event begins and is updated in real-time. Whether it's last minute changes to the programme or interactive room plans, all the important details of a conference are now available around the clock to owners of iPhones and other mobile devices.

